

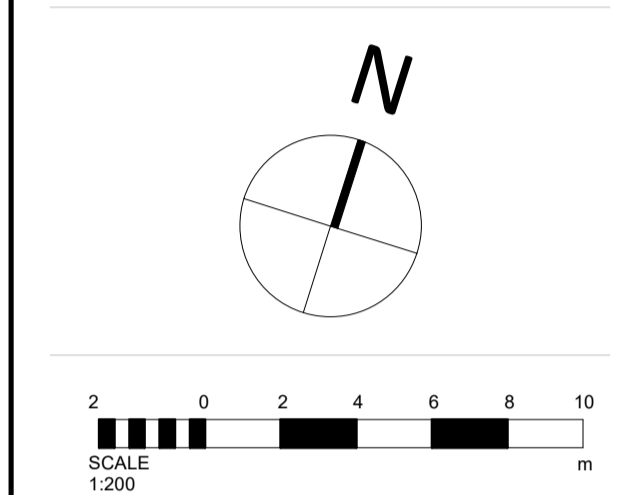

**Notes:**  
 - Do not scale from this drawing. Use figured dimensions in all cases.  
 - Verify dimensions on site and report any discrepancies to the Architect immediately.  
 - This drawing is to be read in conjunction with the Architect's Specification.  
 - © This drawing is copyright and may only be reproduced with the Architect's permission.

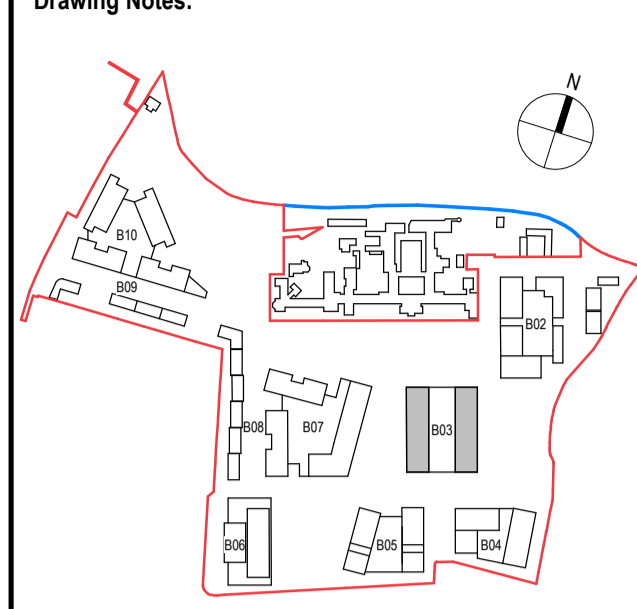

**Planning Legend**

- Site Boundary —
- Residential Entrance ▲
- Service Entrance ▲

- 1B2P
- 2B3P
- 2B4P
- 3B5P
- Amenity
- Restaurant
- Retail

Rev.	Date	Drawn	Details of Issue / Revision
Issues & Revisions			

Darity Mills,  
 Darity Road  
 Dublin 6,  
 D06 Y0E3

T: +353 (0)1 498 7000  
 W: www.reddyarchitecture.com  
 E: info@reddyarchitecture.com

**Applicant Details:**  
 Dún Laoghaire-Rathdown County Council

**Agent Details:**  
 Land Development Agency

**Project Details:**  
 Proposed Part 10 Residential Development,  
 Dundrum Central Development,  
 Dundrum Road,  
 Dublin 14

**Drawing Title:**  
 Block 03, Seventh Floor, GA Plan

Job No. <b>P19-233D</b>	Sheet Size: <b>A1_Landscape</b>	Scale @A1: <b>1 : 200</b>
Issue Date: <b>Sept 2024</b>	Drawn By: <b>K. Potocka</b>	Reviewed By: <b>R. Quinn</b>

Status <b>P3</b>	Purpose of Issue <b>Part 10 Planning Application</b>
Project - System - Spatial Zone - Level - Type - Originator - Role - Number <b>DCD-02-B03-L07-DR-RAU-AR-1307</b>	Revision <b>P3-S-1</b>