

NOTES

- THIS DRAWING IS TO BE READ IN CONJUNCTION WITH ALL ENGINEERS & ARCHITECTS DRAWINGS FIGURED DIMENSIONS ONLY (NOT SCALING) TO BE USED. WHERE A CONFLICT OF INFORMATION EXISTS OR IF IN ANY DOUBT - 'ASK'.
- CONSULTANTS TO BE INFORMED IMMEDIATELY OF ANY DISCREPANCIES BEFORE WORK PROCEEDS.

MAINTENANCE REQUIREMENTS FOR PERMEABLE PAVEMENTS

REGULAR MAINTENANCE
BRUSHING AND VACUUMING (STANDARD COSMETIC SWEEP OVER WHOLE SURFACE). ONCE A YEAR, AFTER AUTUMN LEAF FALL, OR REDUCED FREQUENCY AS REQUIRED, BASED ON SITE-SPECIFIC OBSERVATIONS OF CLOGGING OR MANUFACTURER'S RECOMMENDATIONS - PAY PARTICULAR ATTENTION TO AREAS WHERE WATER RUNS ONTO PVIOUS SURFACE FROM ADJACENT IMPERMEABLE AREAS AS THIS AREA IS MOST LIKELY TO COLLECT THE MOST SEDIMENT

STABILISE AND MOW CONTRIBUTING AND ADJACENT AREAS. FREQUENCY - AS REQUIRED

REMOVAL OF WEEDS OR MANAGEMENT USING GLYPHOSPATE APPLIED DIRECTLY INTO THE WEEDS BY AN APPLICATOR RATHER THAN SPRAYING. FREQUENCY - AS REQUIRED - ONCE PER YEAR ON LESS FREQUENTLY USED PAVEMENTS

REMEDIAL ACTIONS
REMIADIATE ANY LANDSCAPING WHICH, THROUGH VEGETATION MAINTENANCE OR SOIL SLIP, HAS BEEN RAISED TO WITHIN 50mm OF THE LEVEL OF THE PAVING. FREQUENCY - AS REQUIRED

REMEDIAL WORK TO ANY DEPRESSIONS, RUTTING AND CRACKED OR BROKEN BLOCKS CONSIDERED DETRIMENTAL TO THE STRUCTURAL PERFORMANCE OR A HAZARD TO USERS, AND REPLACEMENT OF LOST JOINTING MATERIAL. FREQUENCY - AS REQUIRED

REHABILITATION OF SURFACE AND UPPER SUBSTRUCTURE BY REMEDIAL SWEEPING. FREQUENCY - EVERY 10 TO 15 YEARS OR AS REQUIRED (IF INFILTRATION PERFORMANCE IS REDUCED DUE TO SIGNIFICANT CLOGGING)

MONITORING
INITIAL INSPECTION: MONTHLY FOR THREE MONTHS AFTER INSTALLATION. INSPECT FOR EVIDENCE OF POOR OPERATION AND/OR WEED GROWTH AND IF REQUIRED, TAKE REMEDIAL ACTION

THREE-MONTHLY, 48 H AFTER LARGE STORMS IN FIRST SIX MONTHS: INSPECT SILT ACCUMULATION RATES AND ESTABLISH APPROPRIATE BRUSHING FREQUENCIES.

MONITOR INSPECTION CHAMBERS ANNUALLY

NOTE: ON THIS PROJECT TYPE 'B' SYSTEM WILL APPLY EXCEPT WITHIN 1.5m OF BUILDING FOUNDATION OR 1.5m OF THE SITE BOUNDARY.

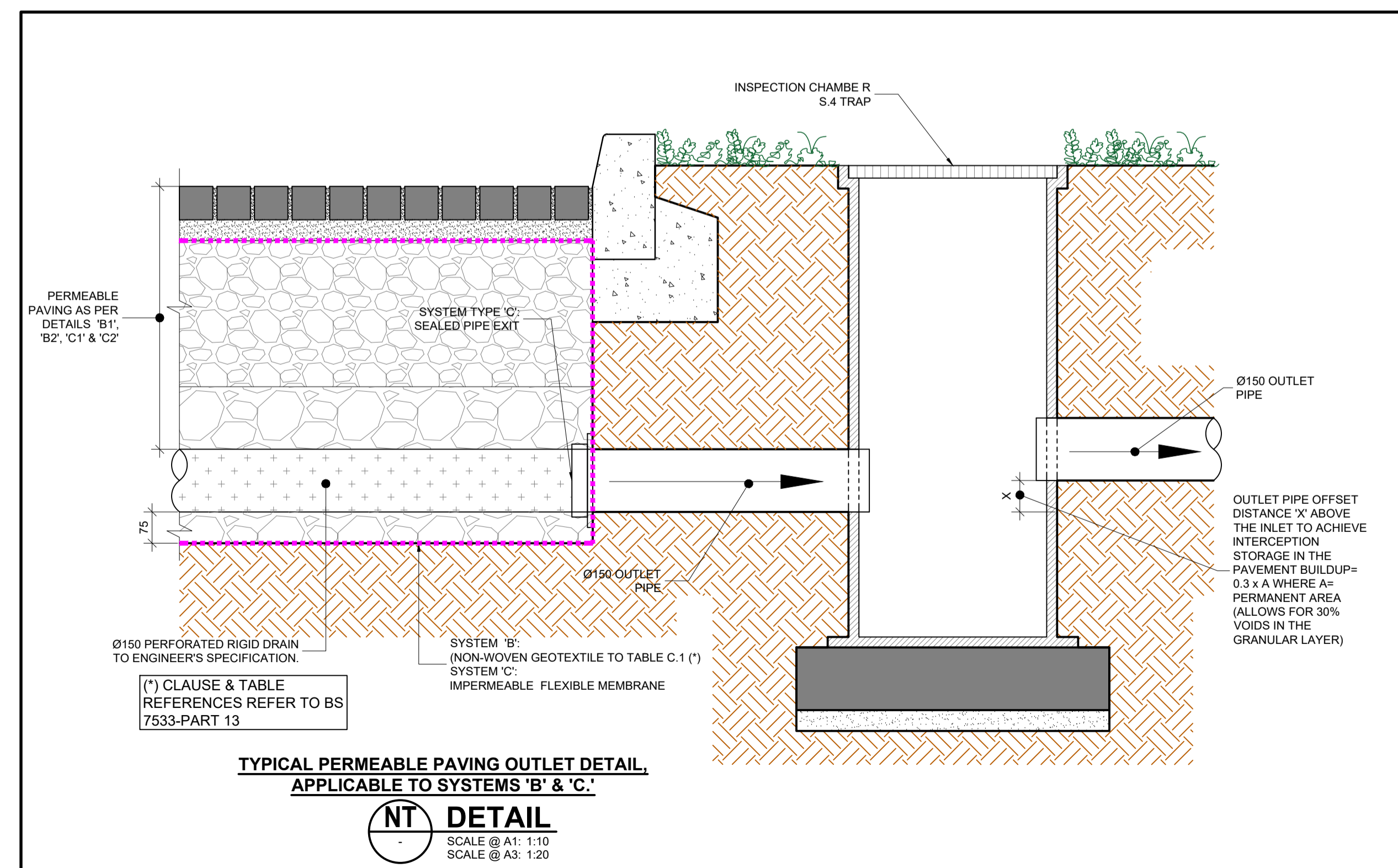
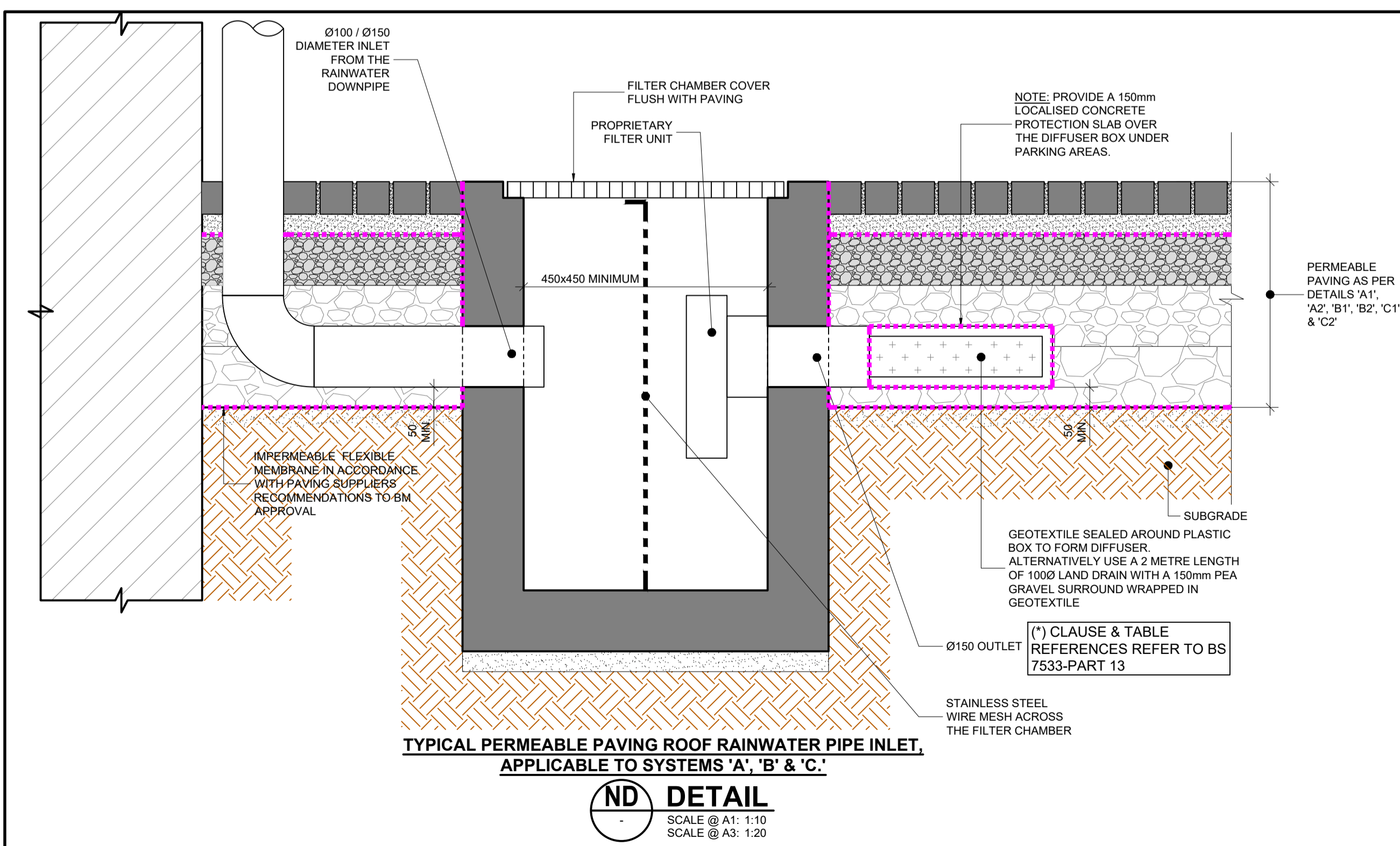
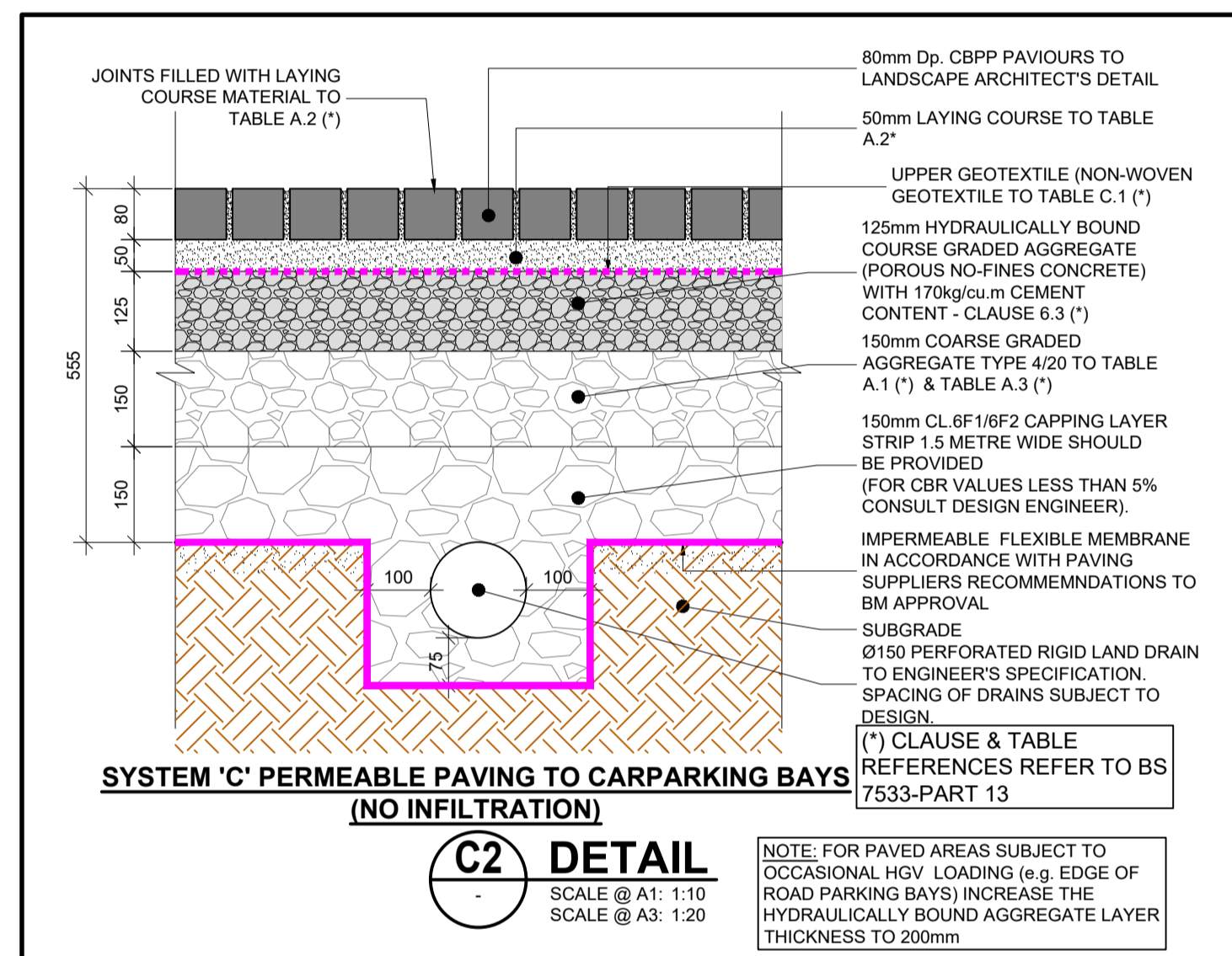
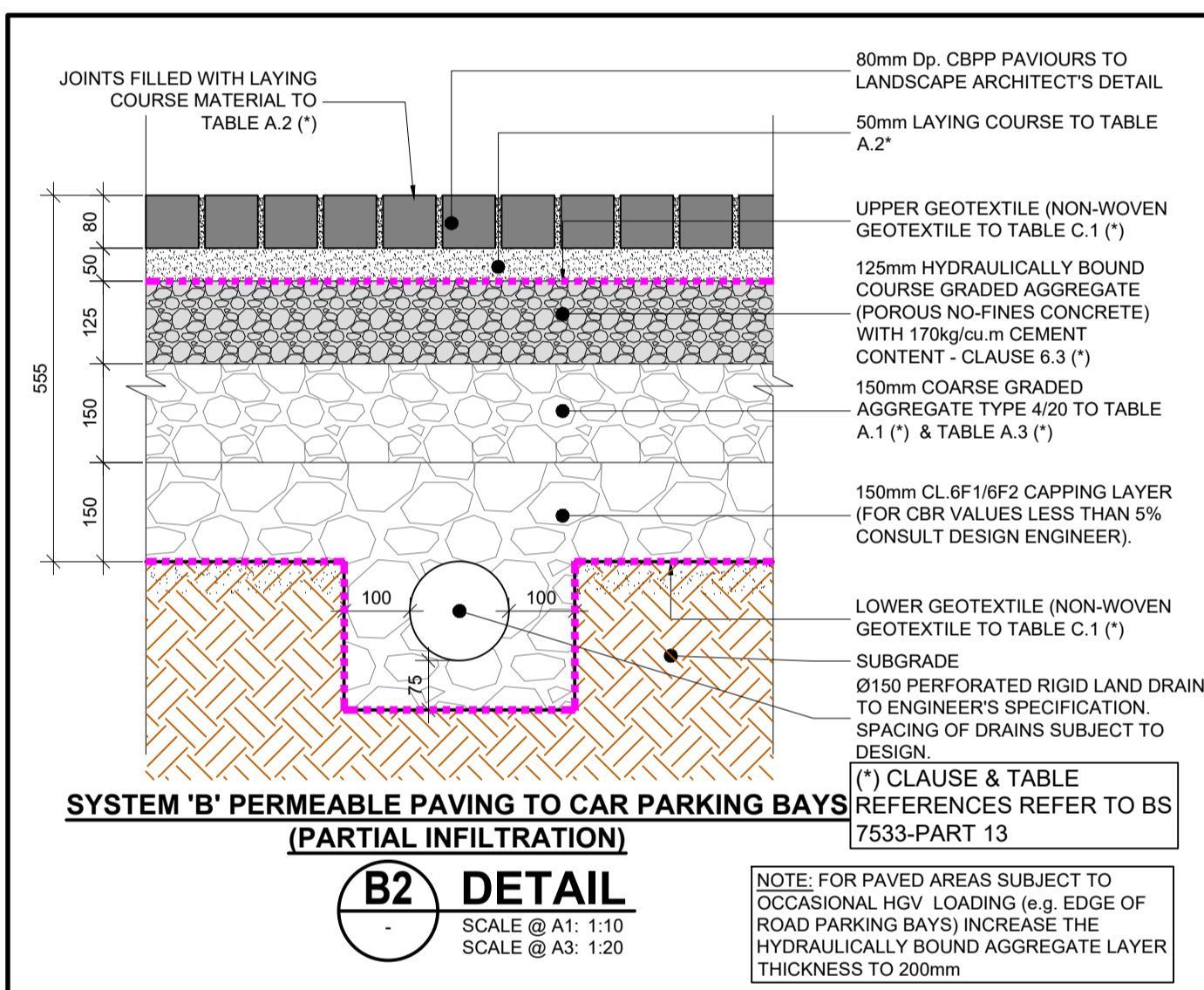
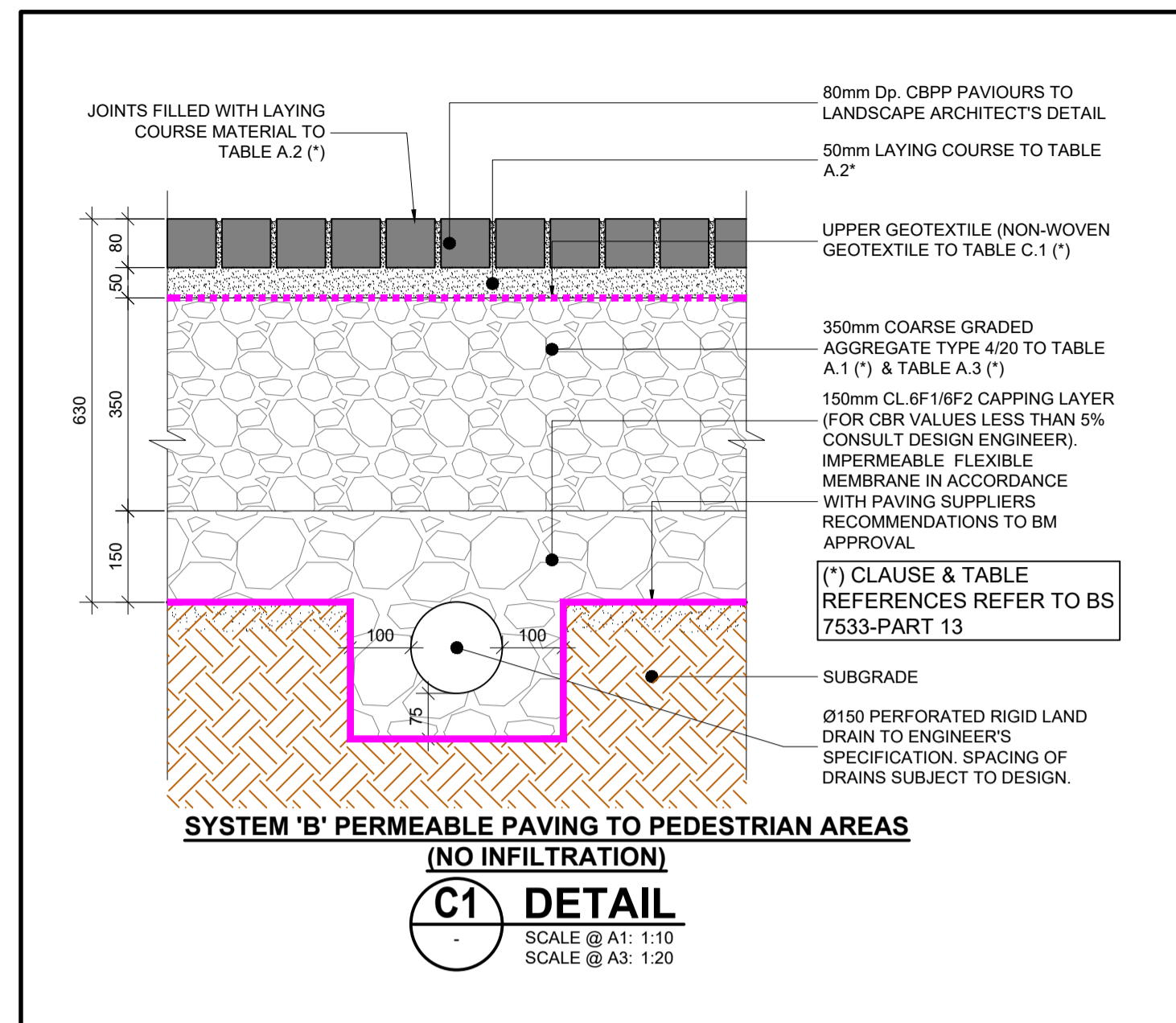
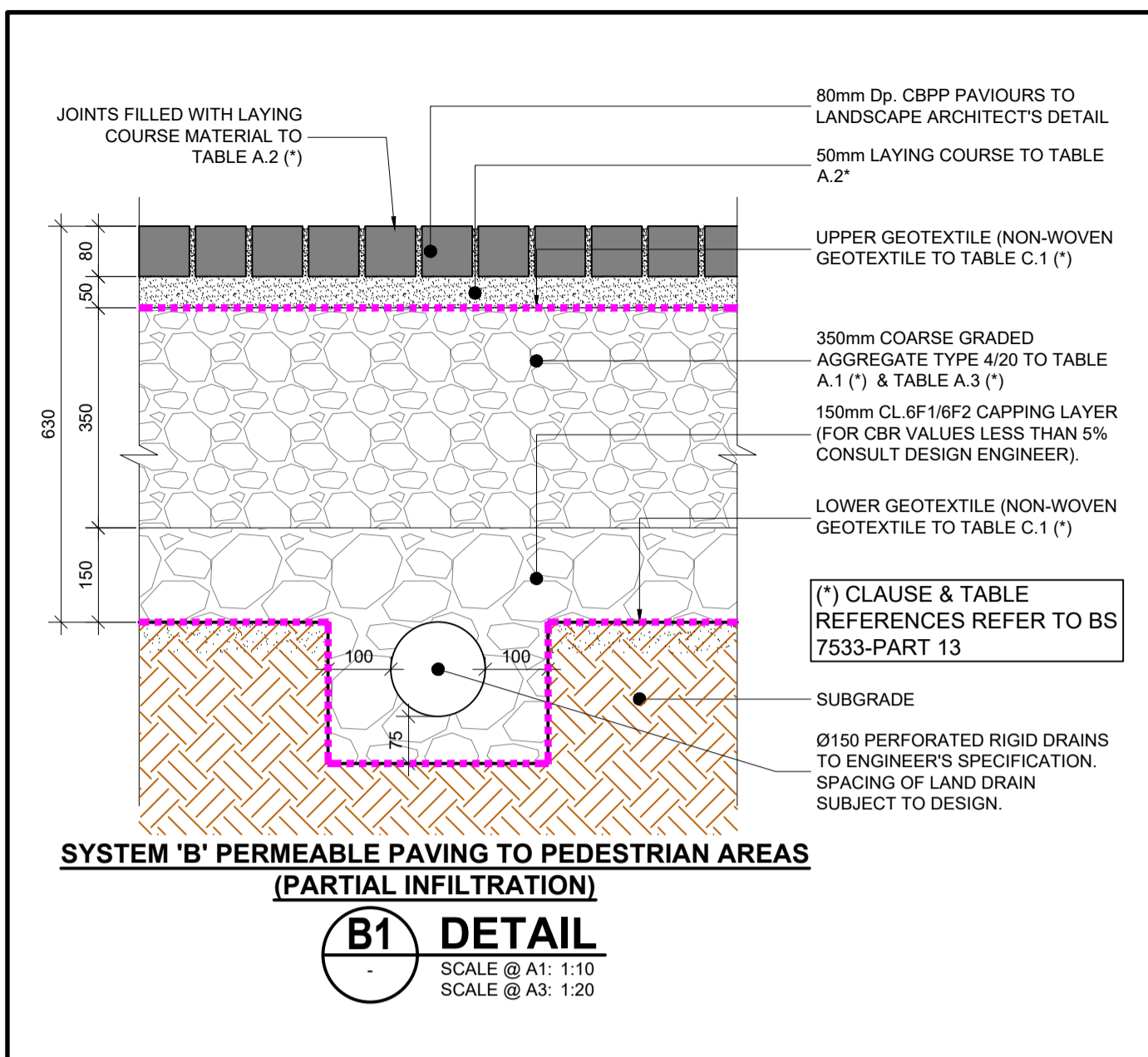

ISSUE	DATE	DESCRIPTION	MR	TRK	POD	IPC
P3	05.09.24	ISSUED FOR PLANNING	MR	TRK	POD	IPC
P2	10.07.24	ISSUED TO LDA FOR COMMENT	MR	TRK	POD	IPC
P1	06.06.24	ISSUED FOR COMMENT	MR	TRK	POD	IPC

PLANNING

BM
Dublin Office: Sandwith House, 52-54 Lower Sandwith Street, Dublin 2, Ireland. Tel: (01) 677 3200 Fax: (01) 677 3164
London Office: 12 Mill Street, London SE1 2AY, United Kingdom. Tel: (0044) 084 5413 2722

Consulting Engineers, Civil, Structural, Project Management. E-mail: bmce@bmce.ie Web: www.bmce.ie

Barrett Mahony
The Institution of Structural Engineers
ACEI
International Federation of Consulting Engineers

APPLICANT: **DÚN LAOGHAIRE-RATHDOWN COUNTY COUNCIL**
AGENT: **LAND DEVELOPMENT AGENCY**
PROJECT TITLE: **PROPOSED PART 10 RESIDENTIAL DEVELOPMENT, DUNDRUM CENTRAL DEVELOPMENT, DUNDRUM ROAD, DUBLIN 14.**
BM PROJECT No.: **20.170**

DRAWING TITLE: **SuDS DETAILS, PERMEABLE PAVING DETAILS.**