

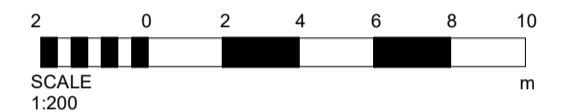

BLOCK 10

**Notes:**  
 - Do not scale from this drawing. Use figured dimensions in all cases.  
 - Verify dimensions on site and report any discrepancies to the Architect immediately.  
 - This drawing is to be read in conjunction with the Architect's Specification.  
 - © This drawing is copyright and may only be reproduced with the Architect's permission.

**Drawing Notes:**

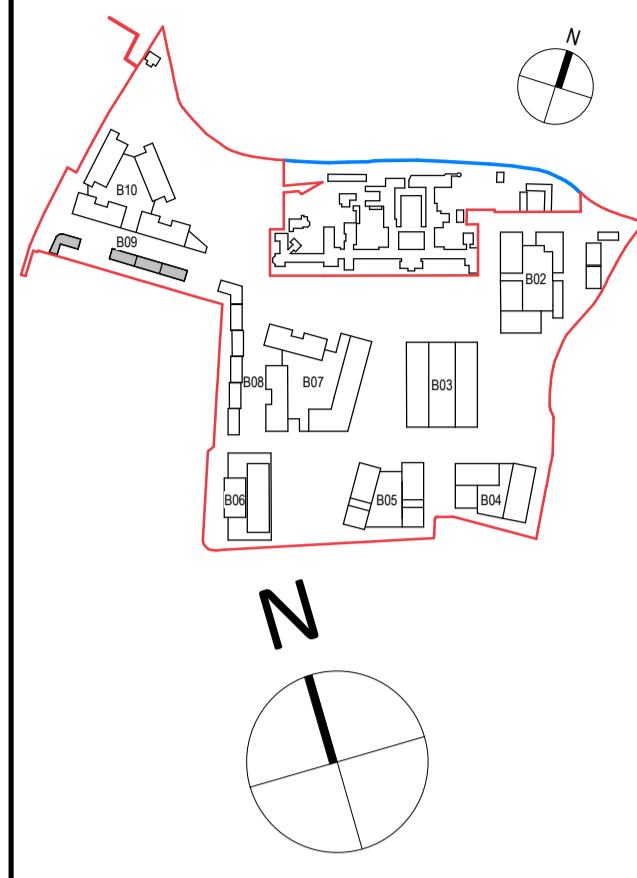

**Planning Legend**

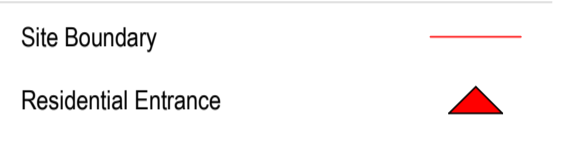

Rev.	Date	Drawn	Details of Issue / Revision
P3 S-1	Sept 2024	KP	Part 10 Planning Application
			Issues & Revisions

**reddy architecture +urbanism**

Dartry Mills,  
 Dartry Road  
 Dublin 6,  
 D06 Y0E3

T: +353 (0)1 498 7000  
 W: www.reddyarchitecture.com  
 E: info@reddyarchitecture.com

**Applicant Details:**  
 Dún Laoghaire-Rathdown County Council

**Agent Details:**  
 Land Development Agency

**Project Details:**  
 Proposed Part 10 Residential Development,  
 Dundrum Central Development,  
 Dundrum Road,  
 Dublin 14

**Drawing Title:**  
 Block 09, Ground Floor, GA Plan

Job No. <b>P19-233D</b>	Sheet Size <b>A1_Landscape</b>	Scale @A1: <b>1 : 200</b>
Issue Date: <b>Sept 2024</b>	Drawn By: <b>K. Potocka</b>	Reviewed By: <b>R. Quinn</b>

**Status:** P3 **Purpose of Issue:** Part 10 Planning Application

Project - System - Spatial Zone - Level - Type - Originator - Role - Number	Revision
DCD-02-B09-L00-DR-RAU-AR-1900	P3 S-1

Block 09 - Ground Floor Plan  
 1 : 200