

DCD-02-B08-ZZZ-DR-RAU-AR-2880

DCD-02-B08-ZZZ-DR-RAU-AR-2901

DCD-02-B08-ZZZ-DR-RAU-AR-2800

DCD-02-B08-ZZZ-DR-RAU-AR-2800

DCD-02-B08-ZZZ-DR-RAU-AR-2880

B8\_RF - Roof Plan  
1 : 200

**Notes:**  
 - Do not scale from this drawing. Use figured dimensions in all cases.  
 - Verify dimensions on site and report any discrepancies to the Architect immediately.  
 - This drawing is to be read in conjunction with the Architect's Specification.  
 - © This drawing is copyright and may only be reproduced with the Architect's permission.

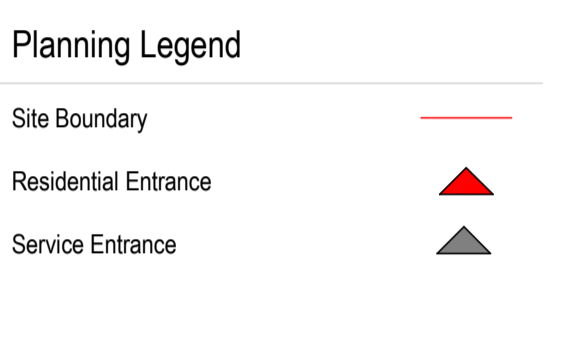
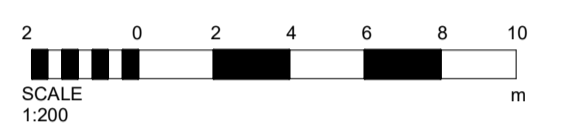
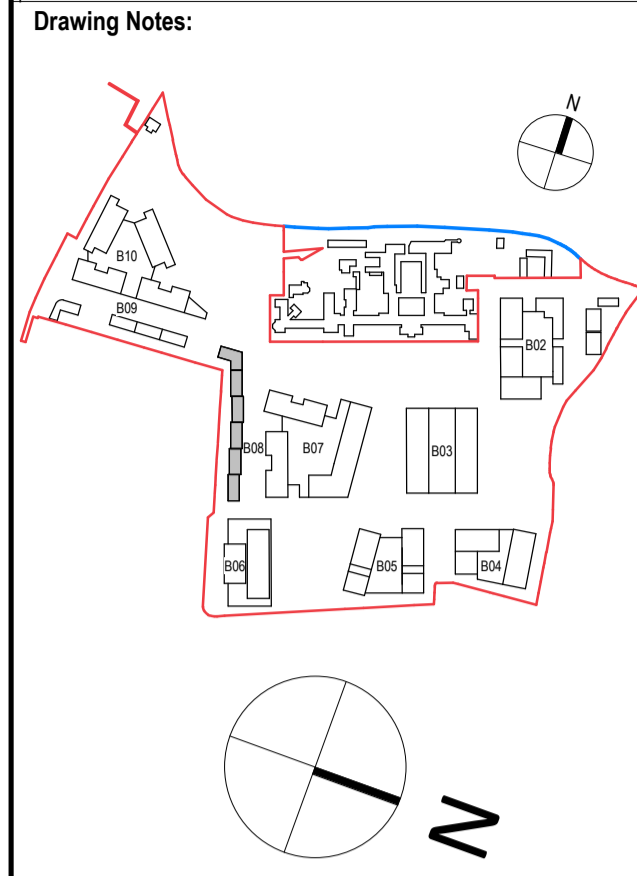

Rev.	Date	Drawn	Details of Issue / Revision
P3 S-1	Sept 2024	KP	Part 10 Planning Application

Issues & Revisions

**reddy architecture + urbanism**

Dartry Mills,  
Dartry Road  
Dublin 6,  
D06 Y0E3

T: +353 (0)1 498 7000  
W: www.reddyarchitecture.com  
E: info@reddyarchitecture.com

Applicant Details:  
**Dún Laoghaire-Rathdown County Council**

Agent Details:  
**Land Development Agency**

Project Details:  
**Proposed Part 10 Residential Development,  
 Dundrum Central Development,  
 Dundrum Road,  
 Dublin 14**

Drawing Title:  
**Block 08, Roof Plans**

Job No. <b>P19-233D</b>	Sheet Size: <b>A1_Landscape</b>	Scale @A1: <b>1 : 200</b>
Issue Date: <b>Sept 2024</b>	Drawn By: <b>K. Potocka</b>	Reviewed By: <b>R. Quinn</b>

Status: **P3** Purpose of Issue: **Part 10 Planning Application**

Project - System - Spatial Zone - Level - Type - Originator - Role - Number	Revision
<b>DCD-02-B08-L03-DR-RAU-AR-1803</b>	<b>P3 S-1</b>