

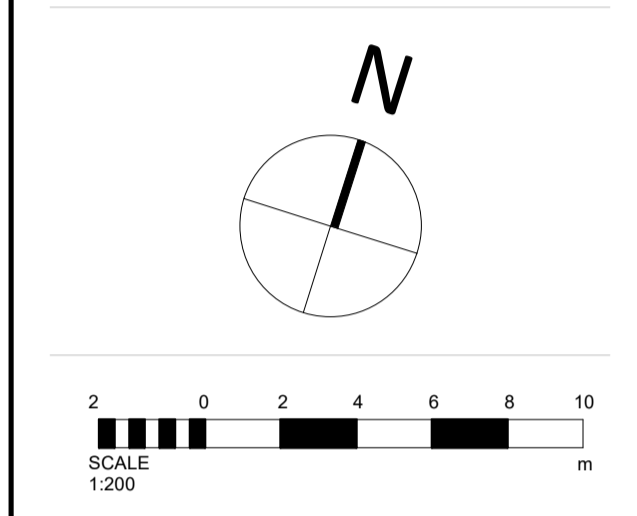

Notes:
 - Do not scale from this drawing. Use figured dimensions in all cases.
 - Verify dimensions on site and report any discrepancies to the Architect immediately.
 - This drawing is to be read in conjunction with the Architect's Specification.
 - © This drawing is copyright and may only be reproduced with the Architect's permission.

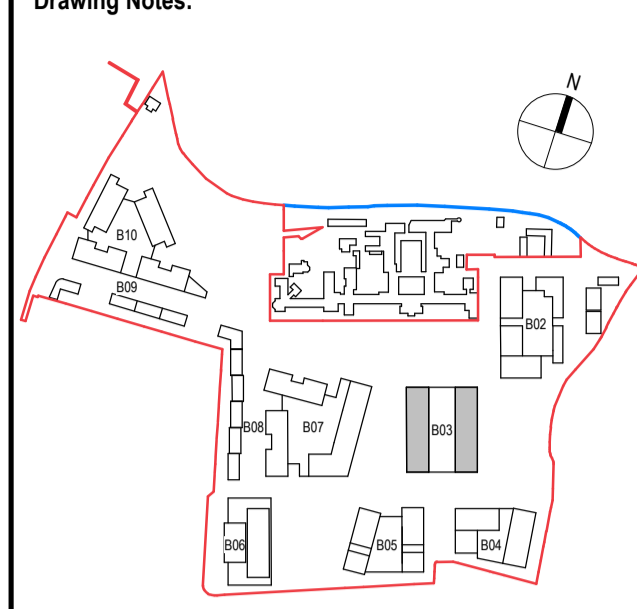

Planning Legend

- Site Boundary —
- Residential Entrance ▲
- Service Entrance ▲

- 1B2P
- 2B3P
- 2B4P
- 3B5P
- Amenity
- Restaurant
- Retail

Rev.	Date	Drawn	Details of Issue / Revision
Issues & Revisions			

Darby Mills,
Darby Road
Dublin 6,
D06 Y0E3

T: +353 (0)1 498 7000
W: www.reddyarchitecture.com
E: info@reddyarchitecture.com

Applicant Details:
Dún Laoghaire-Rathdown County Council

Agent Details:
Land Development Agency

Project Details:
**Proposed Part 10 Residential Development,
 Dundrum Central Development,
 Dundrum Road,
 Dublin 14**

Drawing Title:
Block 03, Sixth Floor, GA Plan

Job No. P19-233D	Sheet Size: A1_Landscape	Scale @A1: 1 : 200
Issue Date: Sept 2024	Drawn By: K. Potocka	Reviewed By: R. Quinn

Status: P3	Purpose of Issue: Part 10 Planning Application
Project - System - Spatial Zone - Level - Type - Originator - Role - Number	
DCD-02-B03-L06-DR-RAU-AR-1306	P3-S-1